



***The Camper with the
Heart of
a Vanagon***



WEEKENDER

The Weekender offers total versatility. It's a second car plus a capable weekend home. Standard Equipment: King Size Seat-to-Bed Conversion—Cabinet with Stainless Steel Sink—Ice Box—Carpeted Floor—Fresh Water Tank—Waste Water Tank—Manual Water Pump—Fluorescent Galley Light—Drapes All Around—Screened Windows—Front Seat Covers—Wired for 110 Volt with 15 Amp Breaker—Table—Dashboard Snack Tray—Center Front Console—Fire Extinguisher.



1. Rear-to-front view, showing bed conversion
2. Kitchen cabinet with ice box and sink
3. Center front console

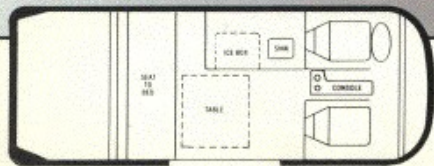
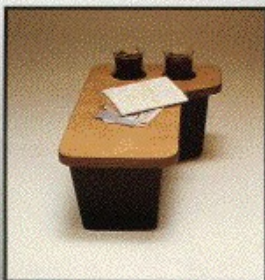

Weight Approx. 3,300 Lbs.
Height Empty 6 Ft., 5 In.



CAMPER

The Camper is the ideal family unit with emphasis on sleeping capacity and total utilization of space. Years of customer acceptance and experience have resulted in this complete home away from home. Standard Equipment: Penthouse Top—Seat-to-Bed Conversion—Front Seat Covers—Carpeted Floor—Cabinet with Stainless Steel Sink—Electric Water Pump, Manual Backup—Waste Water Tank—Fresh Water Tank—Hook-up for City Water—12 Volt/LP Gas Refrigerator—Dual Battery with Isolator—Two Burner Stove—110/12 Volt Converter with Built-in Battery Charger—Table—Screened Windows—Fluorescent Galley Light—Reading Lights—Drapes All Around—Dashboard Snack Tray—Center Front Console—Fire Extinguisher.



1. Kitchen cabinet with sink, stove and refrigerator
2. Rear-to-front view, showing bed conversion and storage units
3. Penthouse and lower beds

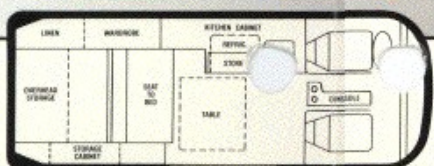
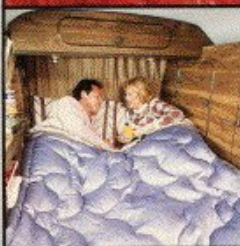
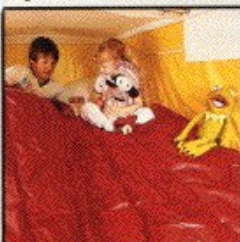

Weight Approx. 3,760 Lbs.
Height Empty 6 Ft., 10 In.



CONVERTA-VAN

This neat combination can be a station wagon, family car, or an overnighter. It is an inexpensive and unique way to seat seven or sleep two with the added touch of a warm interior and privacy drapes. Standard Equipment: King Size-Split Bed—Front Seat Covers—Carpeted Floor—Drapes—Window Screens—Two Rear-Facing Seats—Table—Dashboard Snack Tray—Center Front Console.



1. Rear-to-front view, bed split with seat up
2. Bed and two rear-facing seats
3. Dashboard snack tray

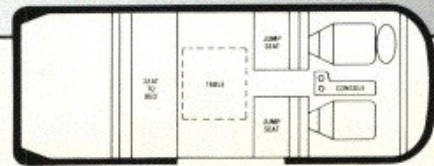
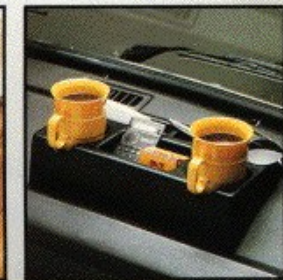

Weight Approx. 3,268 Lbs.
Height Empty 6 Ft., 5 In.

Accessory Options



Seat with storage area for portable toilet. Attractive dual-purpose unit.

Ottoman—versatile seating unit, and alternative cover for portable toilet.



Portable Toilet—convenient and compact necessity.



Tent attaches to camper, or use free-standing (save your campsite while away in your camper); sturdy, and simple to erect. 7'x8' floor space, 6' wall height.



Galley Cabinet—optional extended storage and counter space for Camper and Weekender models.

More options for your convenience

Hammock—add youngster's bed easily, across front seat area; 80 lb. capacity

Portable legs—makes an outdoor table out of your indoor camper table.

Factory Swivel Base—adds swivel feature to front passenger seat.

Mosquito Net—screen for rear door area.

Awning—6'x8' protective overhead extension to side of camper.



Furnace—8400 BTU output, thermostatically controlled, highly efficient.

VEHICLE SPECIFICATIONS ARE LISTED IN VOLKSWAGEN OF AMERICA'S
VANAGON BROCHURE • YOUR SALESMAN WILL PROVIDE YOU WITH A COPY

NOTE: Please ask for a copy of the camper kit maintenance and warranty manual.

WARRANTY

Every A.S.J. Camper Kit carries a one year/20,000 mile (Limited) Warranty to the original owner on materials and workmanship by its manufacturer, except for such items as appliances, which are covered by the warranties of their respective manufacturers. The basic motor vehicle for each Vanagon is covered by the warranty of its manufacturer. Ask your salesman for copies of all such warranties. They are available.

All specifications are subject to change without notice. For exterior color consult Volkswagen Vanagon brochure.

Optional equipment and color combinations are subject to change without notice.

